

Wine & Bottle Packaging 2024



Features

- 1 Wooden Bottle Boxes
- 2 Rigid Folding Wine Boxes
- 3 Italian Wine Packaging
- 9 Wine & Bottle Bags

New! *Wooden Bottle Boxes*

 **4-Color Process Print**

Minimum 24 Pieces

Eco-Friendly Boxes

100% FSC Certified Pine Wood

Single Slide Closure

Lid slides from top along recessed side channels

Bottle Dividers

2-Bottle Box includes removable divider and has securely knotted rope handle.



Price per EACH

Product Code	Size	Ctn
Process Printed Wooden Bottle Boxes		
PR-WWBB1W	One Bottle - 13-1/2" x 3-1/2" x 3-1/2"	12
PR-WWBB2W	Two Bottle - 13-1/2" x 7" x 3-1/2"	12

Price above includes one side printing, product and ALL set up charges.

Must be ordered in full cases.

Production Time: 7-10 business days from proof approval

Subject to review of artwork and pricing if print area exceeds 75% of print surface.

Exact PMS colors are not possible as all colors are converted to CMYK. Reference a Pantone PMS color bridge to see how your PMS color will appear. Prices subject to review of art. Additional charges may apply to orders with excess ink coverage.

Unprinted Wooden Bottle Boxes

1 Unit = 1 Carton

Product Code	Size	Ctn	Actual (Ship) Wt
Wooden Bottle Boxes			
WW-BB1W	One Bottle - 13-1/2" x 3-1/2" x 3-1/2"	12	14 (21)
WW-BB2W	Two Bottle - 13-1/2" x 7" x 3-1/2"	12	22 (38)

Rigid Folding Wine Boxes



4-Color Process Print

Minimum 50 Boxes

- Black Matte Anti Scratch finish now in 2-bottle
- Ships flat, easy open & fully collapsible
- Magnetic Closure
- Full length inserts included for BB2

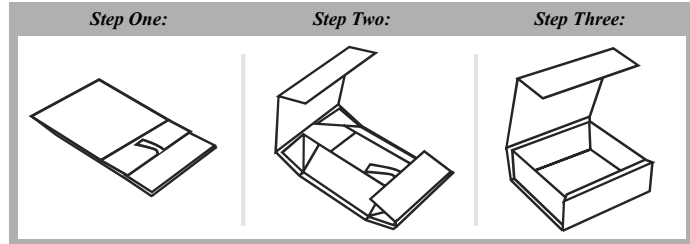

Price per EACH

Product Code	Style	Actual Wt
Process Printed - Rigid Folding Wine Boxes: Matte Black (MBLA) w/ Anti Scratch Finish & White Gloss (GWHI)		
PR-RFBB1___	13-1/2 x 3-1/2 x 3-1/2 (White Gloss Only)	0.8
PR-RFBB2___	13-1/2 x 7 x 3-1/2 w bottle inserts	1.1

Unprinted Boxes

Product Code	Style	Actual Ship Wt
White Gloss Finish (GWHI)		
RF-XBB1GWHI	13-1/2 x 3-1/2 x 3-1/2	0.8
RF-XBB2GWHI	13-1/2 x 7 x 3-1/2 w bottle inserts	1.1
Black Matte (MBLA) with Anti Scratch Finish		
RF-XBB2MBLA	13-1/2 x 7 x 3-1/2 w bottle inserts	1.1

Wine Carriers & Boxes



4-Color Process Print

Minimum 60 Boxes

Price includes
One Side Printing, Product,
and ALL Setup Charges!

Price per EACH

Product Code	Style	Size	Ctn
Wine Bottle Carriers			
PR-ITBS1___	Sculpted 1 Bottle Carrier	3-1/2 x 3-1/2 x 15	100
PR-ITBC1___	1 Bottle Carrier	3-1/2 x 3-1/2 x 15	50
PR-ITBC2___	2 Bottle Carrier	7 x 3-1/2 x 15	30
PR-ITBC3___	3 Bottle Carrier	10-5/8 x 3-1/2 x 15	30
PR-ITWT4___	4 Bottle Open Style	7 x 7 x 13-3/4	30
PR-ITWT6___	6 Bottle Open Style	10-5/8 x 7 x 13-3/4	30
Wine Bottle Boxes			
PR-ITBBMNER	Magnum 1 Bottle Box	4-1/2 x 4-1/2 x 16-3/4	20
PR-ITBB1___	1 Bottle Box (Side Opening)	3-3/4 x 3-3/4 x 13-3/8	100
PR-ITBBV1TAW	1 Bottle Box (End Opening)	3-1/2 x 3-1/2 x 13-3/8	50
PR-ITBB2___	2 Bottle Box (IT prefix)	7-1/4 x 3-1/2 x 13-3/8	30
PR-ITBB3___	3 Bottle Box (IT prefix)	11 x 3-1/2 x 13-3/8	30

Price above includes one side printing, product and ALL set up charges.

Must be ordered in full cases.

Production Time: 7-10 business days from proof approval

Subject to review of artwork and pricing if print area exceeds 75% of print surface.

Exact PMS colors are not possible as all colors are converted to CMYK. Reference a Pantone PMS color bridge to see how your PMS color will appear. Prices subject to review of art. Additional charges may apply to orders with excess ink coverage.

Italian Wine Packaging



"Nero"
Matte Black Linen
Bottle Carriers,
Bottle Side-Opening
and \Bottle Boxes w/ inserts

"Natural Kraft"
Smooth Finish
Bottle Carriers,
and Bottle Boxes w/ inserts

New Style!
Hex Carriers
1 & 2 Bottle Carriers

1 Unit = 1 Package

Product Code	Style	Size	Ctn	Actual (Ship) Weight	
"Nero" Matte Black Linen (NER)					SS
<i>New!</i> IT-HXBC1NER	1B Hex Carrier w/Rope	3-3/4" x 3-3/4" x 14	50	11 (12)	
<i>New!</i> IT-HXBC2NER	2B Hex Carrier w/Rope	8" x 3-3/4" x 14	30	11 (11)	
IT-BS1NER	BS1 Carrier	3-1/2" x 3-1/2" x 15"	100	17 (20)	
IT-BC1NER	1B Carrier	3-1/2" x 3-1/2" x 15"	50	12 (12)	
IT-BC2NER30	2B Carrier w/Window	7" x 3-1/2" x 15"	30	11 (11)	
IT-BC3NER30	3B Carrier w/Window	10-5/8" x 3-1/2" x 15"	30	15 (15)	
IT-BBMNER	1B Magnum	4-1/2" x 4-1/2" x 16-3/4"	20	9 (9)	
IT-BB1NER	1B Box (Horizontal)	3-3/4" x 3-3/4" x 13-3/8"	100	37 (37)	
IT-BB2NER	2B Box (w/inserts)	7-1/4" x 3-1/2" x 13-3/8"	30	22 (22)	
IT-BB3NER	3B Box (w/inserts)	11" x 3-1/2" x 13-3/8"	30	27 (27)	
IT-WT4NER	4 bottles - Nero (Black Linen)	7" x 7" x 13-3/4"	30	12 (14)	
IT-WT6NER	6 bottles - Nero (Black Linen)	10-5/8" x 7" x 13-3/4"	30	17 (17)	
Natural Kraft Smooth Finish (NAT)					SS
<i>New!</i> IT-HXBC1NAT	1B Hex Carrier w/Rope	3-3/4" x 3-3/4" x 14	50	11 (12)	
<i>New!</i> IT-HXBC2NAT	2B Hex Carrier w/Rope	8" x 3-3/4" x 14	30	11 (11)	
IT-BC1NAT	1B Carrier w/Window	3-1/2" x 3-1/2" x 15"	50	12 (12)	
IT-BC2NAT30	2B Carrier w/Window	7" x 3-1/2" x 15"	30	11 (11)	
IT-BC3NAT30	3B Carrier w/Window	10-5/8" x 3-1/2" x 15"	30	15 (15)	
IT-BBV1NAT	1B Box (Top Opening)	3-1/2" x 3-1/2" x 15"	50	13 (13)	
IT-BB2NAT	2B Box (w/inserts)	7-1/4" x 3-1/2" x 13-3/8"	30	22 (22)	
IT-BB3NAT	3B Box (w/inserts)	11" x 3-1/2" x 13-3/8"	30	27 (28)	
IT-WT4NAT	4 bottles - Natural Kraft	7" x 7" x 13-3/4"	30	12 (14)	
IT-WT6NAT	6 bottles - Natural Kraft	10-5/8" x 7" x 13-3/4"	30	17 (17)	

Screen Printing Information

Minimum 100 Pieces

Italian Wine Packaging

Add charges below to plain product pricing - Per 100 pieces

	1 Color	2 Colors	3 Colors
1 side			
Minimum Print Charge			
Less than 1000 pcs			
1000 pcs			
3000 pcs			
5000 pcs			

Italian Wine Packaging



"Pelle Marrone"
Chocolate Pebble
2 & 3 Bottle Carriers

"Juta Blu"
Matte Navy Linen
Bottle Carriers,
and Bottle Boxes w/ inserts
E-Commerce Boxes

"White Kraft"
Smooth Finish

1 Unit = 1 Ctn

Product Code	Style	Size	Ctn	Actual (Ship) Weight	
White Kraft Smooth Finish (WHI)					SS
IT-BC2WHI	2B Carrier w/Window	7" x 3-1/2" x 15"	30	11 (11)	
IT-BC3WHI	3B Carrier w/Window	10-5/8" x 3-1/2" x 15"	30	15 (15)	
IT-WT4WHI	Open Style, 4 bottles	7" x 7" x 13-3/4"	30	12 (14)	
IT-WT6WHI	Open Style, 6 bottles	10-5/8" x 7" x 13-3/4"	30	17 (17)	
"Juta Blu" Matte Navy Linen (NAV) & "Pelle Marrone" Chocolate Pebble (PMA)					SS
IT-BC2__	2B Carrier w/Window	7" x 3-1/2" x 15"	30	11 (11)	
IT-BC3__	3B Carrier w/Window	10-5/8" x 3-1/2" x 15"	30	15 (15)	
IT-BB2NAV	2B Box (w/inserts)	7-1/4" x 3-1/2" x 13-3/8"	30	22 (22)	
IT-BB3NAV	3B Box (w/inserts)	11" x 3-1/2" x 13-3/8"	30	27 (27)	

Screen Printing Information

Minimum 100 Pieces

Add charges below to plain product pricing - Per 100 pieces

	1 Color	2 Colors	3 Colors
1 side	Minimum Print Charge		
	Less than 1000 pcs		
	1000 pcs		
	3000 pcs		

4-Color Process Print

Minimum 60 Boxes

Price includes:
One Side Printing, Product, and ALL Setup Charges!

Product Code	Style	Size	Ctn	Actual (Ship) Weight	Price per EACH
Wine Bottle Carriers					
PR-ITBC2__	2 Bottle Carrier	7 x 3-1/2 x 15	30	11 (11)	
PR-ITBC3__	3 Bottle Carrier	10-5/8 x 3-1/2 x 15	30	15 (15)	
PR-ITWT4__	4 Bottle Open Style	7 x 7 x 13-3/4	30	12 (14)	
PR-ITWT6__	6 Bottle Open Style	10-5/8 x 7 x 13-3/4	30	17 (17)	
Wine Bottle Boxes					
PR-ITBB2__	2 Bottle Box (IT prefix)	7-1/4 x 3-1/2 x 13-3/8	30	22 (22)	
PR-ITBB3__	3 Bottle Box (IT prefix)	11 x 3-1/2 x 13-3/8	30	27 (27)	

Price above includes one side printing, product and ALL set up charges.

Must be ordered in full cases.
Production Time: 7-10 business days from proof approval
Subject to review of artwork and pricing if print area exceeds 75% of print surface.

Exact PMS colors are not possible as all colors are converted to CMYK. Reference a Pantone PMS color bridge to see how your PMS color will appear. Prices subject to review of art. Additional charges may apply to orders with excess ink coverage.

Italian Wine Packaging



"Constellation"
Smooth Finish
1, 2 & 3 Bottle Carriers



"Sfere Bianco"
Bubble Texture
1 & 2 Bottle Carriers



"Grigio"
Gray Groove
1, 2 & 3 Bottle Carriers



"Pelle Rosso"
Red Pebble
2 & 3 Bottle Carriers

Product Code	Style	Size	Colors	Ctn	Actual (Ship) Weight	1 Unit = 1 Package
"Constellation" Smooth Finish (CON)						SS
IT-BC1CON	1B Carrier	3-1/2" x 3-1/2" x 15"		50	12 (12)	
IT-BC2CON	2B Carrier w/Window	7" x 3-1/2" x 15"		30	11 (11)	
IT-BC3CON	3B Carrier w/Window	10-5/8" x 3-1/2" x 15"		30	15 (15)	
"Sfere Bianco" White Bubbles (SBI), "Grigio" Gray Groove (GRI) & "Pelle Rosso" Red (PRO)						SS
IT-BC1__	1B Carrier w/Window	3-1/2" x 3-1/2" x 15"	GRI & SBI	50	12 (12)	
IT-BC2__30	2B Carrier w/Window	7" x 3-1/2" x 15"	All Colors	30	11 (11)	
IT-BC3__30	3B Carrier	10-5/8" x 3-1/2" x 15"	GRI & PRO	30	15 (15)	

IT Color Collection



(CON) (WHI) (NAV) (NAT) (WOO) (SNO) (ARG) (SBI) (PRO) (ORO) (PMA) (GRI) (NER) (TAW)

Screen Printing Information

Minimum 100 Pieces

Italian Wine Packaging

Add charges below to plain product pricing - Per 100 pieces

	1 Color	2 Colors	3 Colors
Minimum Print Charge			
Less than 1000 pcs			
1000 pcs			
3000 pcs			
5000 pcs			



Italian Wine Packaging



“Alpine Snowflake”
Linen Embossed
1, 2 & 3 Bottle Carriers,
Boxes, & Bags



“Oro”
Matte Gold Linen
Bottle Carriers,
Bottle Boxes w/ inserts
and Bottle Side-Opening



“Barn Wood”
Satin Embossed
1, 2 & 3 Bottle Carriers
Bottle Boxes w/ inserts



“Argento”
Metallic Silver Linen Foil
1, 2 & 3 Bottle Carriers,
Bottle Boxes w/ inserts
and Bottle Side-Opening

1 Unit = 1 Package

Product Code	Style	Size	Ctn	Actual (Ship) Weight	
“Alpine Snowflake” (SNO) Linen Texture & “Barn Wood” Satin Embossed (WOO)					SS
IT-BC1___	1 bottle carrier	3-1/2" x 3-1/2" x 15"	50	12 (12)	
IT-BC2___	2 bottle carrier	7" x 3-1/2" x 15"	30	11 (11)	
IT-BC3___	3 bottle carrier	10-5/8" x 3-1/2" x 15"	30	15 (15)	
IT-BB1SNO	1 bottle box	3-3/4" x 3-3/4" x 13-3/8"	100	31 (33)	
IT-BB2___	2 bottle box	7-1/4" x 3-1/2" x 13-3/8"	30	22 (25)	
IT-BB3___	3 bottle box	11" x 3-1/2" x 13-3/8"	30	27 (28)	
LTD Qty IT-SH7SNO	Shopping Bag	7-1/2" x 3-1/2" x 9-3/4"	100	19 (21)	
LTD Qty IT-SH9SNO	Shopping Bag	9" x 4" x 12-3/4"	100	11 (12)	
LTD Qty IT-SH12SNO	Shopping Bag	12-1/8" x 4-3/4" x 15"	100	13 (17)	
“Oro” Matte Gold Linen (ORO)					SS
IT-BS1ORO	BS1 Carrier	3-1/2" x 3-1/2" x 15"	100	17 (20)	
IT-BC1ORO	1B Carrier	3-1/2" x 3-1/2" x 15"	50	12 (12)	
IT-BC2ORO30	2B Carrier w/Window	7" x 3-1/2" x 15"	30	11 (11)	
IT-BC3ORO30	3B Carrier w/Window	10-5/8" x 3-1/2" x 15"	30	15 (15)	
IT-BB1ORO	1B Box (Horizontal)	3-3/4" x 3-3/4" x 13-3/8"	100	37 (37)	
IT-BB2ORO	2B Box (w/inserts)	7-1/4" x 3-1/2" x 13-3/8"	30	22 (22)	
IT-BB3ORO	3B Box (w/inserts)	11" x 3-1/2" x 13-3/8"	30	27 (27)	
“Argento” Metallic Silver Foil (ARG) Linen Embossed Texture					SS
IT-BC2ARG30	2B Carrier w/Window	7" x 3-1/2" x 15"	30	11 (11)	
IT-BC3ARG30	3B Carrier w/Window	10-5/8" x 3-1/2" x 15"	30	15 (15)	
IT-BB2ARG	2B Box (w/inserts)	7-1/4" x 3-1/2" x 13-3/8"	30	22 (25)	
IT-BB3ARG	3B Box (w/inserts)	11" x 3-1/2" x 13-3/8"	30	27 (28)	
LTD Qty IT-BB1ARG	1B Box (Horizontal)	3-3/4" x 3-3/4" x 13-3/8"	100	31 (33)	

Spun Oro Wine Boxes & Carriers

2025!

Introducing NEW Spun Oro!

Product will start arriving November of 2024.

This updated texture presents a richer matte gold color when compared to Seta Oro, which will be retiring from our wine packaging program.

Being Retired!

New!



Seta Oro



Spun Oro



BB1, BB2, BB3

BC2

BC3

*"Spun Oro"
Matte Gold Embossed
(SORO)*

BC1

BBV1

Product Code	Style	Size	Ctn	Actual (Ship) Weight	1 Unit = 1 Ctn
"Spun Oro" Matte Gold Embossed (SORO)					SS
IT-BBV1SORO	1B Box (Top Opening)	3-1/2" x 3-1/2" x 15"	50	13 (13)	
IT-BC1SORO	1B Carrier	3-1/2" x 3-1/2" x 15"	50	12 (12)	
IT-BC2SORO30	2B Carrier w/Window	7" x 3-1/2" x 15"	30	11 (11)	
IT-BC3SORO30	3B Carrier w/Window	10-5/8" x 3-1/2" x 15"	30	15 (15)	
IT-BB1SORO	1B Box (Side Opening)	3-3/4" x 3-3/4" x 13-3/8"	100	37 (37)	
IT-BB2SORO	2B Box (w/inserts)	7-1/4" x 3-1/2" x 13-3/8"	30	22 (22)	
IT-BB3SORO	3B Box (w/inserts)	11" x 3-1/2" x 13-3/8"	30	27 (27)	

Slivv Protective Paper Sleeves for Bottles

100% recycled paper sleeves provide a renewable protective alternative to plastic bubble wrap. Unique corrugated shock-absorbing design allows for flat storage and easy packaging, while featuring a bottom closure to keep your wine or other fragile items in place during transit.



Product Code	Style	Size	Actual (Ship)		1 Unit = 1 Ctn
			Ctn	Weight	
Slivv Paper Bottle Transport Sleeves - 100% Recycled Material					
EP-SLMINI	2-2.25" dia. bottles (375 ml / 12 oz)	2.4" x 9.4"	150	8 (10)	
EP-SLPRO	2.75-3.25" dia bottles (375 to 750 ml)	3" x 11.8"	100	8 (10)	
EP-SLMEGA	3.75-4.5" dia bottles (750 ml to 1.5 L)	3.9" x 13.4"	100	9 (17)	

Italian Wine Packaging



Product Code	Style	Size	Colors	Actual (Ship)		1 Unit = 1 Ctn
				Ctn	Weight	
Textured Rib Colors: Bordeaux (BOR), Tawny (TAW) & Red (RED)						
IT-BC2TAW	2B Carrier	7" x 3-1/2" x 16"	TAW Only	30	7 (15)	
IT-BC3TAW	3B Carrier	10-5/8" x 3-1/2" x 16"	TAW Only	30	10 (18)	
IT-BC4TAW	4B Carrier	7" x 7" x 13"	TAW Only	20	11 (12)	
IT-BB1TAW	1B Horizontal	3-1/2" x 3-1/2" x 13-1/4"	TAW Only	100	37 (37)	
IT-BBV1TAW	1B Box (Top Opening)	3-1/2" x 3-1/2" x 13-3/8"	TAW Only	50	5 (14)	
IT-BB2TAW	2B Box (w/inserts)	7-1/4" x 3-1/2" x 13-3/8"	TAW Only	30	7 (13)	
IT-BB3TAW	3B Box (w/inserts)	11" x 3-1/2" x 13-3/8"	TAW Only	30	27 (27)	